

VILLAGE OF ELLSWORTH



SOURCES:
 EXISTING LAND USE, VILLAGE OF ELLSWORTH
 PARCEL INFORMATION, ANNEUR CO. EQUALIZATION
 MAP PRODUCTION: SHAY AND HEIDINGS & ASSOCIATES

FEBRUARY 2006

EXISTING LAND USE MAP



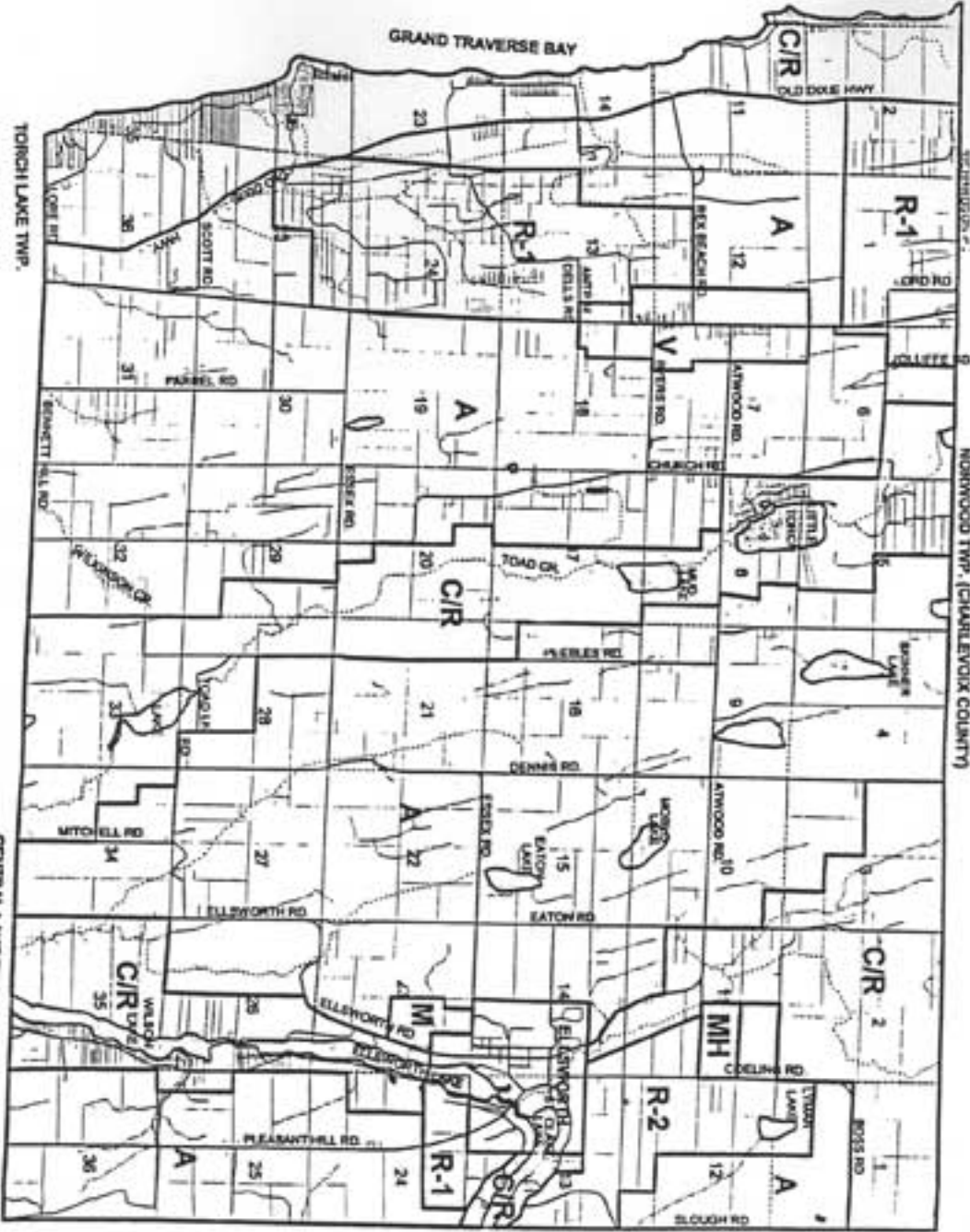

SOUTH ARM TWP. (CHARLEVOIX COUNTY)

**BANKS TOWNSHIP
ZONING MAP**
ANTRIM COUNTY, MICHIGAN
EFFECTIVE DATE: 1-17-02

- PARCELS**
SECTION LINES
ROADS AND STREETS
US-31
RIVERS AND STREAMS

- Zoning Districts**
A Agricultural District
C/R Conservation/ Recreation District
M Manufacturing District
MH Mobile Home District
R-1 Low Density Residential District
R-2 Medium Density Residential District
V Village District
Lakes



Base File Source: MDTG
Covering Source: MDTG (Unknown)

Map of Banks Township, Michigan
Prepared by the Antrim County Planning Department
1000 W. State Street, Suite 200
Antrim, Michigan 49810
Phone: (616) 932-2100
Fax: (616) 932-2101
E-mail: info@antrimcountymi.gov

VILLAGE OF ELLSWORTH

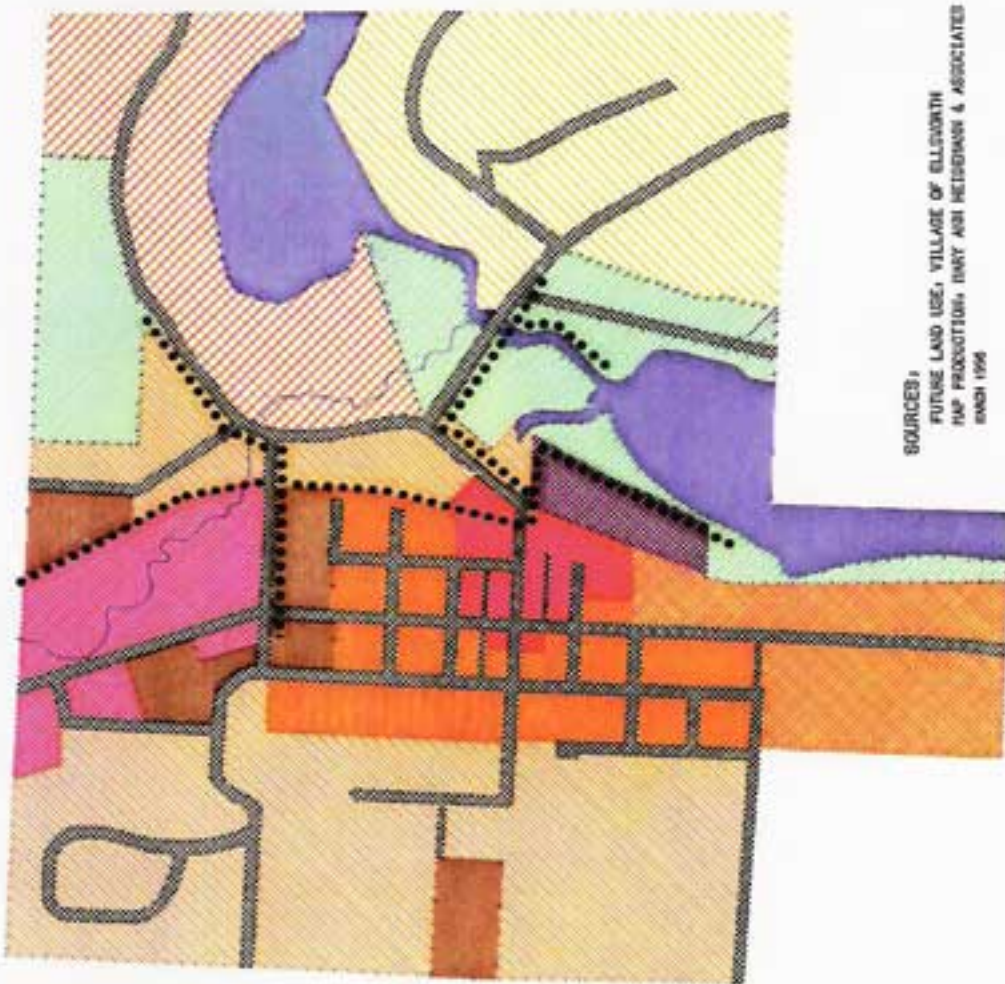

SOURCES:
 FUTURE LAND USE, VILLAGE OF ELLSWORTH
 MAP PRODUCTION, DARY ARI WEISSMAN & ASSOCIATES
 MARCH 1996

FUTURE LAND USE MAP

RECREATION/CONSERVATION

RESIDENTIAL

VILLAGE

MULTIPLE-FAMILY

GENERAL

ESTATE

COMMERCIAL

VILLAGE

GENERAL

TOURISM

PUBLIC SERVICE

SPECIAL DEVELOPMENT AREA

FUTURE TRAIL



NORTHWEST MICHIGAN Ten County Region

▲ Indicates State Parks

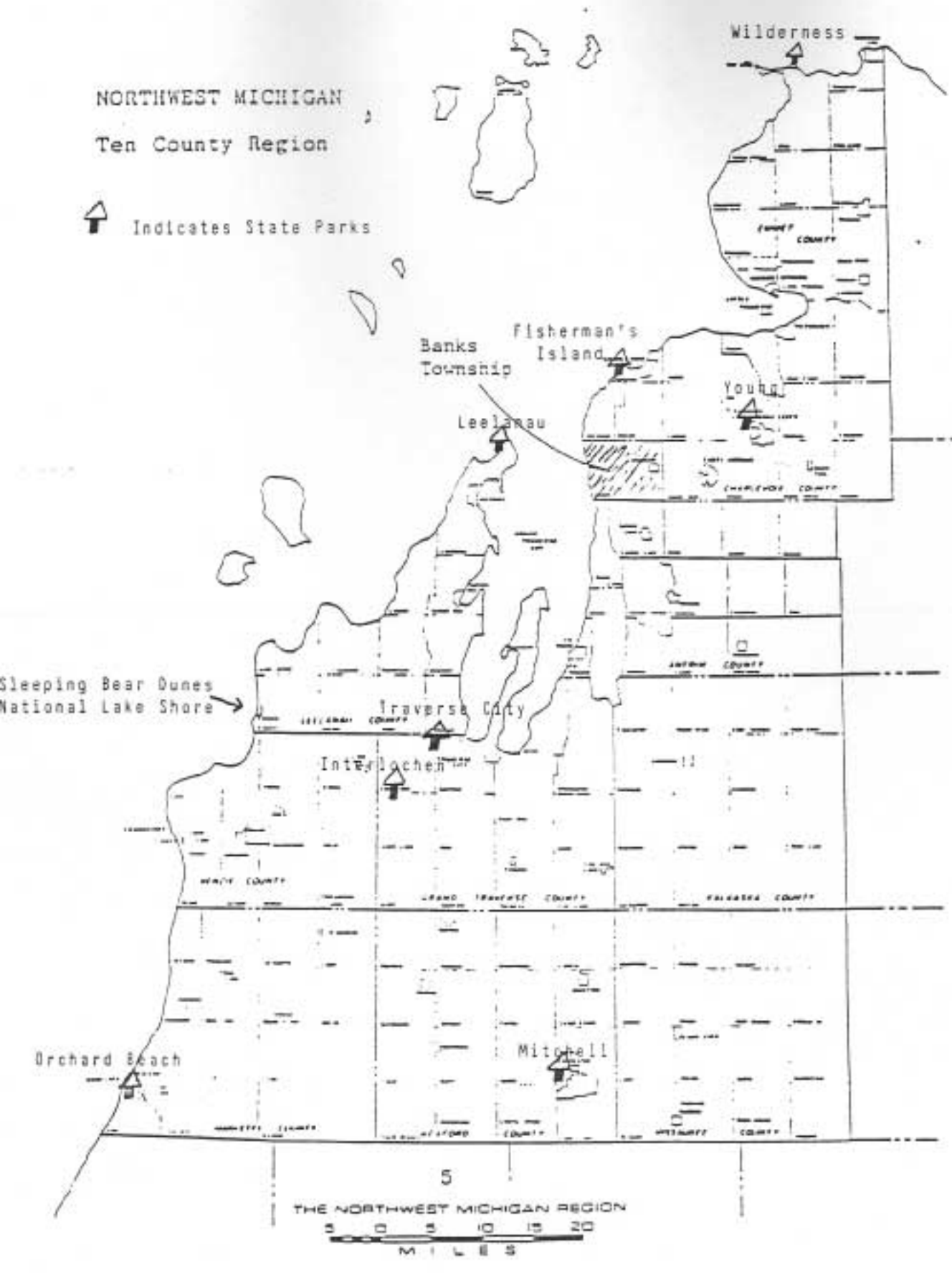

5
 THE NORTHWEST MICHIGAN REGION
 0 5 10 15 20
 MILES

VILLAGE OF ELLSWORTH

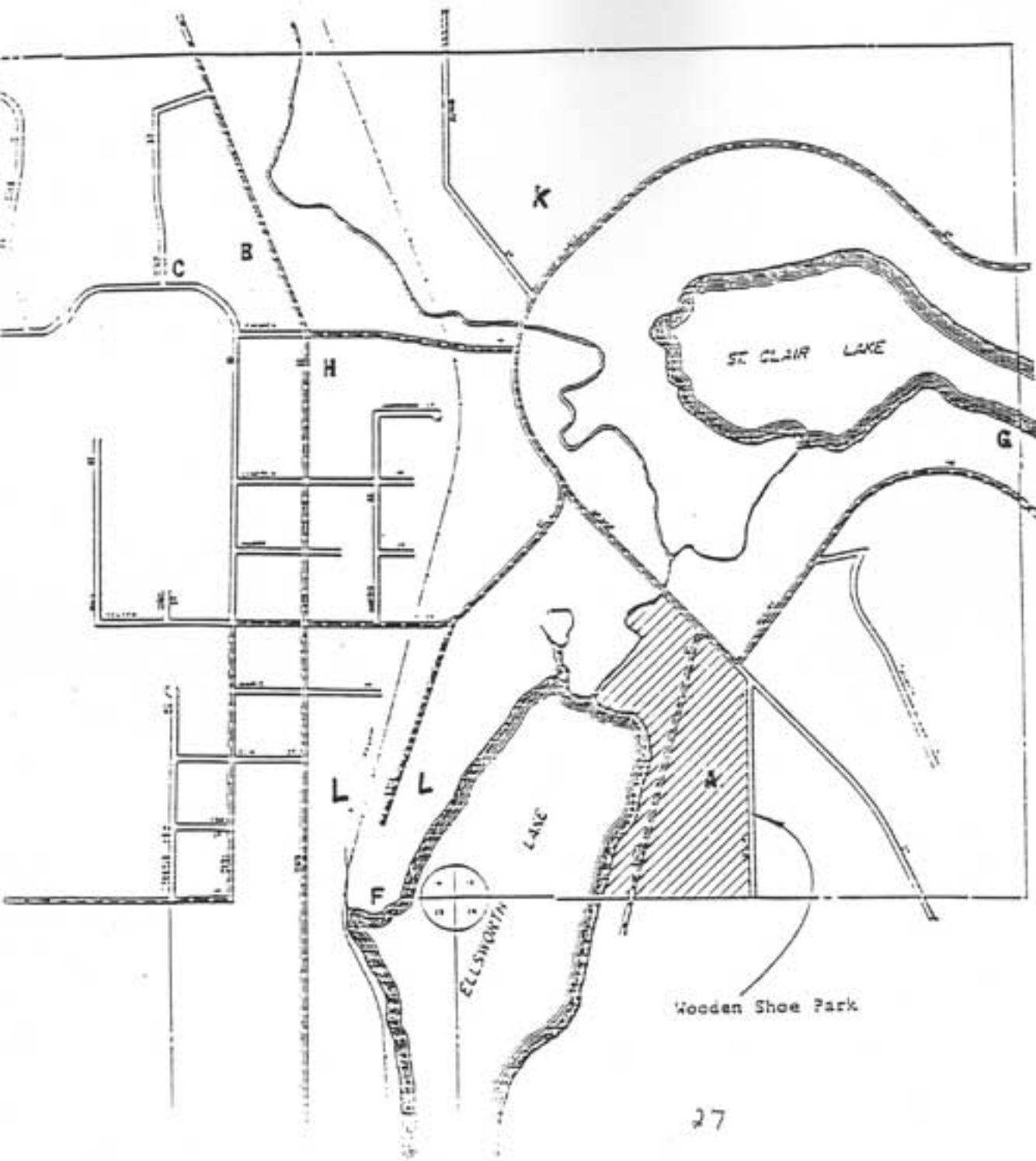

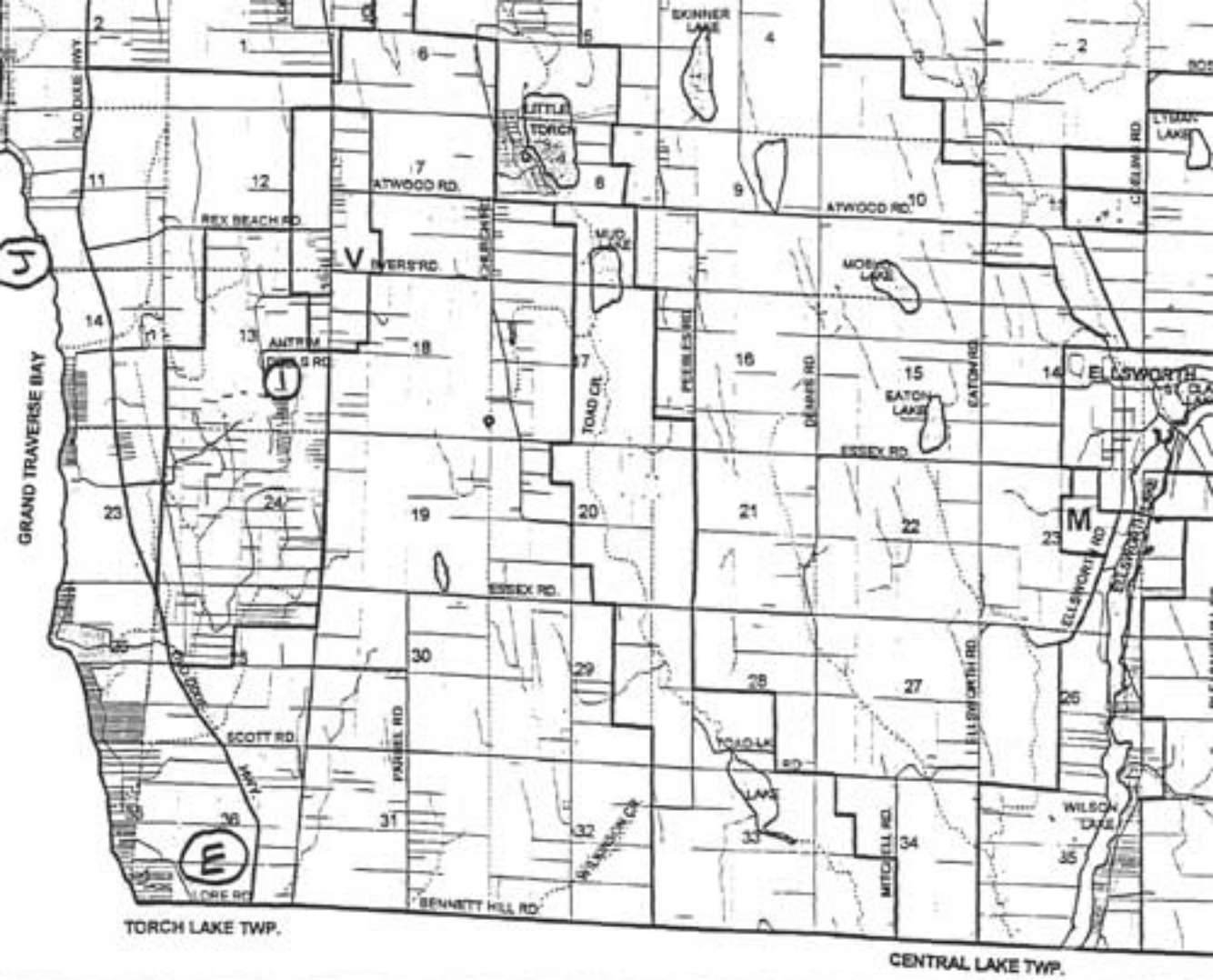

SCHOOL DISTRICT MAP



Barrier Free Status of Parks

Park Name	Parking	Restroom	Pavilion	Drinking Fountain	Picnic Area	Play Equipment	Trails	Sidewalk	Bench	Water Access
Ellsworth Community Park	P	P	P	P	NA	P	NA			
Wooden Shoe Park (Upper Area)		P		P						
Lower Park				NA						
Village Athletic Complex			NA			NA	P			
Village Tennis Courts				P						
Lions Club Basketball Court				P						
Banks Township Park	H	H								
Antrim Creek Natural Area										

H = Handicap Accessible P= Proposed
NA = Not Applicable / Feature or Facility not present

Ellsworth Community Park – This park is currently undeveloped. This park is located in the heart of Ellsworth and is a high priority in terms of re-development. The site was turned over to the Village following an extensive MDEQ clean up of contamination from former industrial activities. Plans are being prepared to develop this park as with a handicap accessible pavilion, restrooms, picnic areas, parking area landscaping and a labyrinth. This site will serve as one end of a proposed multi-purpose pathway and provide accessible restrooms and parking for pathway users.

Wooden Shoe Park (Upper Portion)—This park primarily consists of a 60 site campground on two levels. While none of the sites are officially designated as handicap accessible sites, the campground has been managed in a way to offer the sites on the upper level to anyone with physical movement limitations. The Village proposes to add a separate accessible unisex restroom/ shower facility, as well as providing some accessible picnic tables at some of the sites.

MAP LOCATING PROPOSED AREAS AND FACILITIES TO BE ACCOMPLISHED
OVER THE NEXT FIVE (5) YEARS

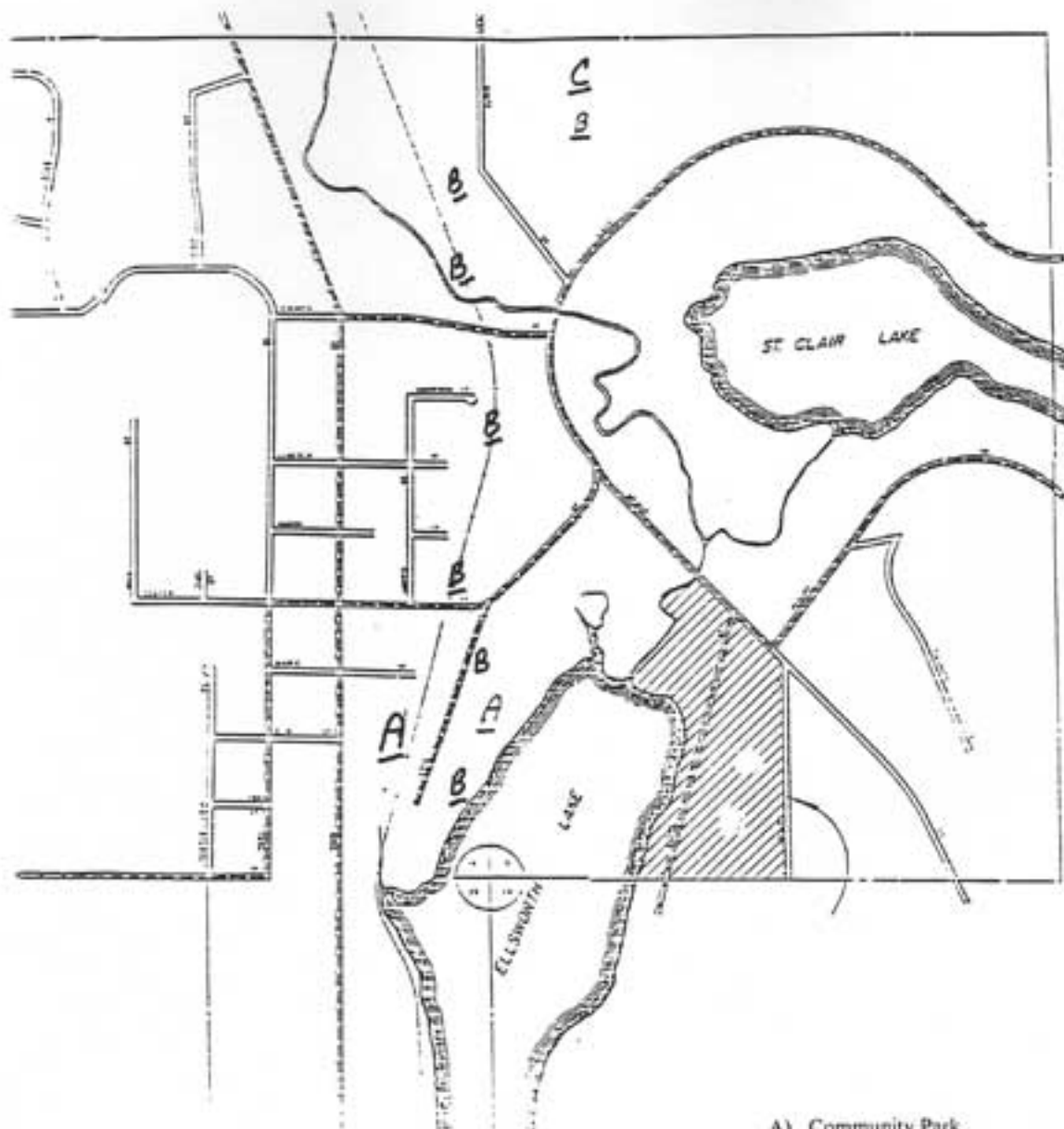

- A) Community Park
- B) Non Motorized Pathway
- C) Land Acquisition

MAP LOCATING PROPOSED AREAS AND FACILITIES TO BE ACCOMPLISHED
OVER THE NEXT FIVE (5) YEARS



D) Banks Township Park